

Revisions		
Number	Description	Date

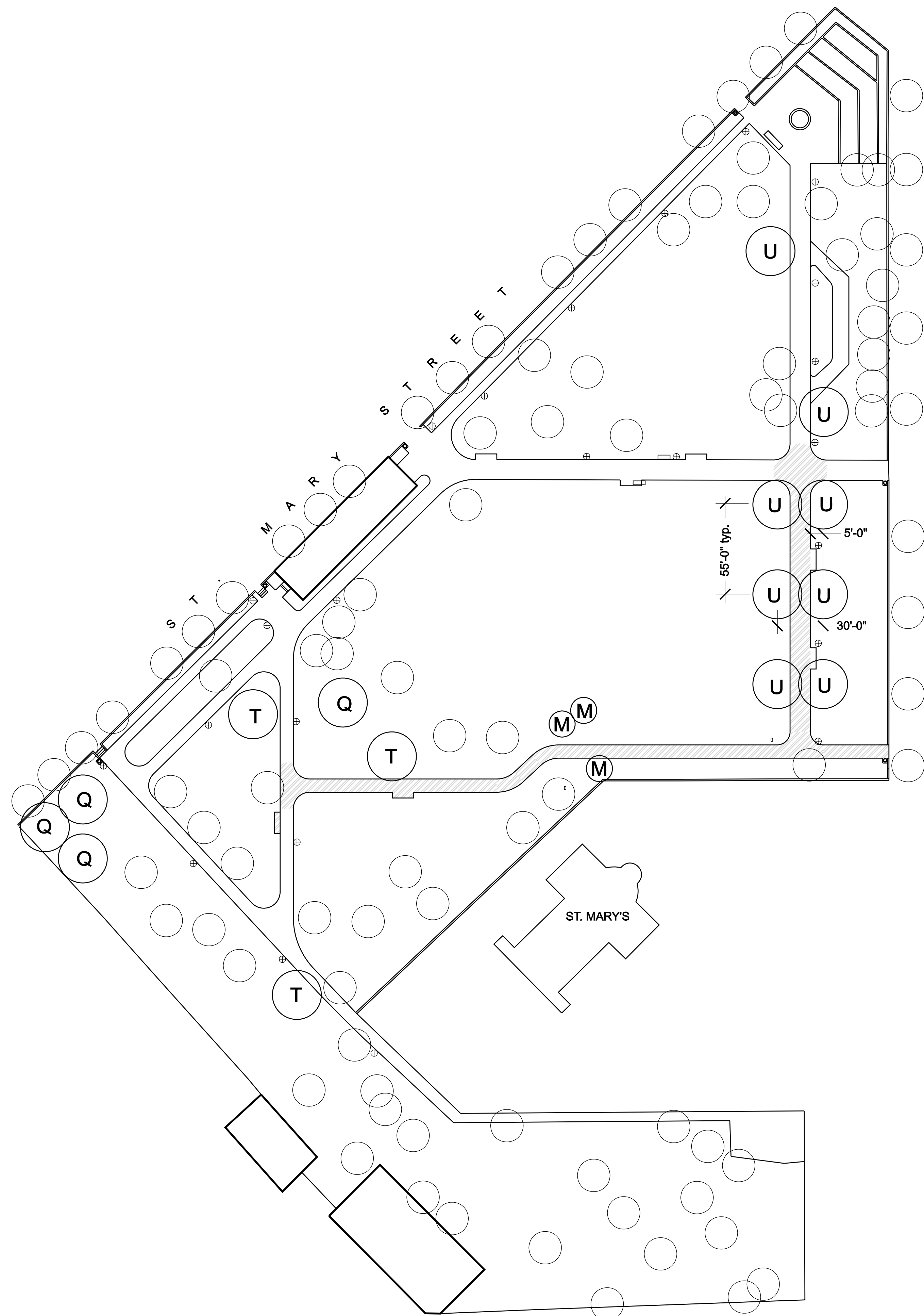

CANOPY TREES					
QTY	KEY	BOTANICAL/COMMON NAME	SIZE	SPACING	ROOT
4	Q	Quercus rubra Red Oak	3- 3 1/2" cal.	As shown	B & B
3	T	Tilia cordata 'Greenspire' Little Leaf Linden	3- 3 1/2" cal.	As shown	B & B
8	U	Ulmus americana 'Princeton' American Elm	3- 3 1/2" cal.	As shown	B & B
ORNAMENTAL TREES					
QTY	KEY	BOTANICAL/COMMON NAME	SIZE	SPACING	ROOT
3	M	Magnolia x soulangiana 'Betty' Saucer Magnolia	10' Ht.	As shown	B & B

PLANTING NOTES:

- Plant Identification** - All plants shall be properly marked for identification and checking.
- Plant Quality** - plants shall be sound, free of plant disease, infestation, or insect eggs and shall have a healthy, normal root system. Plants shall be freshly dug and not heeled-in stock, nor stock from cold storage. All plants shall be nursery grown. Plants shall not be pruned prior to delivery. The shape of the plant shall, in general, conform to its natural growth proportions unless otherwise specified. All plants, including container grown, shall conform to the branching, caliper and height specifications of the American Association of Nurserymen's Publication entitled *American Standard for Nursery Stock, ANSI Z60.1-2004* or latest edition, and shall have a well-shaped, heavy-branched structure for the species. Evergreen trees are to have an internode no greater than 24" and shall be uniformly well-shaped. Plants of a given size shall not measure less than the minimum size as set forth in the *American Standard for Nursery Stock, ANSI Z60.1-2004* or latest edition.
- Soil Mix** - Soil mix will be 2/3 existing topsoil, 1/3 leafmold thoroughly mixed and homogenized. Other organic material may be substituted upon written approval by ODG.
- Rootball Size** - The ball size shall conform to the American Association of Nurserymen's Publication entitled *American Standard for Nursery Stock, ANSI Z60.1-2004* or latest edition, and shall be wrapped in untreated burlap.
- Planting** - Backfilling shall be reasonably free of stones, subsoil, clay, lumps, stumps, roots, weeds, Bermuda grass, litter, toxic substances, or any other material which may be harmful to plant growth or hinder grading, planting, or maintenance operations. Should any unforeseen or unsuitable planting conditions arise, such as faulty soil drainage, chemical residues or inconsistencies between plans and actual site conditions, they should be called to the attention of ODG and the owner for adjustment before planting. Plants shall be set plumb and straight and trees shall be guyed or staked, where required, at the time of planting. Backfill shall be well worked about the roots and seated by watering. Plants will be planted higher than surrounding grade. Shrubs and trees will be set at a depth to place 1/8" of the rootball above finish grade. Remove rope from round tree trunks and lay back burlap and wire baskets from top 1/3 of all B&B material. Nylon, plastic, or vinyl rope and/or burlap will be completely removed from all plant material prior to planting.
- Cultivation** - The area around isolated plants shall be mulched to at least a 6" greater diameter than that of the hole.
- Maintenance** - The Contractor shall be responsible during the contract and up to the time of acceptance for keeping the planting and work incidental thereto in good condition by replanting, plant replacement, watering, weeding, cultivating, pruning, spraying, restaking and cleaning up, and by performing all other necessary operations of care for the promotion of good plant growth so that all work is in satisfactory condition at the time of acceptance at no additional cost to the owner.
- Fertilizer & Inoculation** - All fertilizer shall be granular, with 35 to 80 percent of the total nitrogen in a slowly available form. For trees, shrubs, and groundcover; fertilizer shall be a complete fertilizer with a minimum analysis of 10 percent nitrogen, 6 percent phosphorus and 4 percent potassium. For perennials, annuals, and bulbs; fertilizer shall be a time-released, high-phosphate fertilizer; i.e., osmacote. For bulbs, fertilizer shall be bone meal (commercial, raw and finely-round), with an analysis of 4 percent nitrogen and 20 percent phosphoric acid.
Fertilizer shall be added depending on the size of the plant and the manufacturer's recommendation using the following application rates:
1. Trees: Use 2 lb. of 10-6-4 fertilizer per inch of trunk diameter.
- Guarantee and Replacement** - All plant material shall be unconditionally guaranteed for one year. The guarantee will begin on the date of final acceptance of the work. After a plant has been determined to be dead, dying or damaged from handling or installation, it will be replaced during the next growing season. For example, if a plant is found dead during the summer months, it will be replaced during the fall planting season. The guarantee will end for all plant material one year after acceptance. During the guarantee period, the Contractor will not be responsible for mechanical injury or vandalism caused by other parties.
- Material Inspection** - Owner and/or ODG shall, at their discretion, inspect plant material before and during delivery and installation.

General:
Call Miss Utility before an excavation or digging (800)-257-7777
Review extent of work for possible conflicts in accessibility, staging, stockpile, and scheduling with the Tree Protection Zones and coordinate work efforts and schedule with Landscape Architect or Owner.

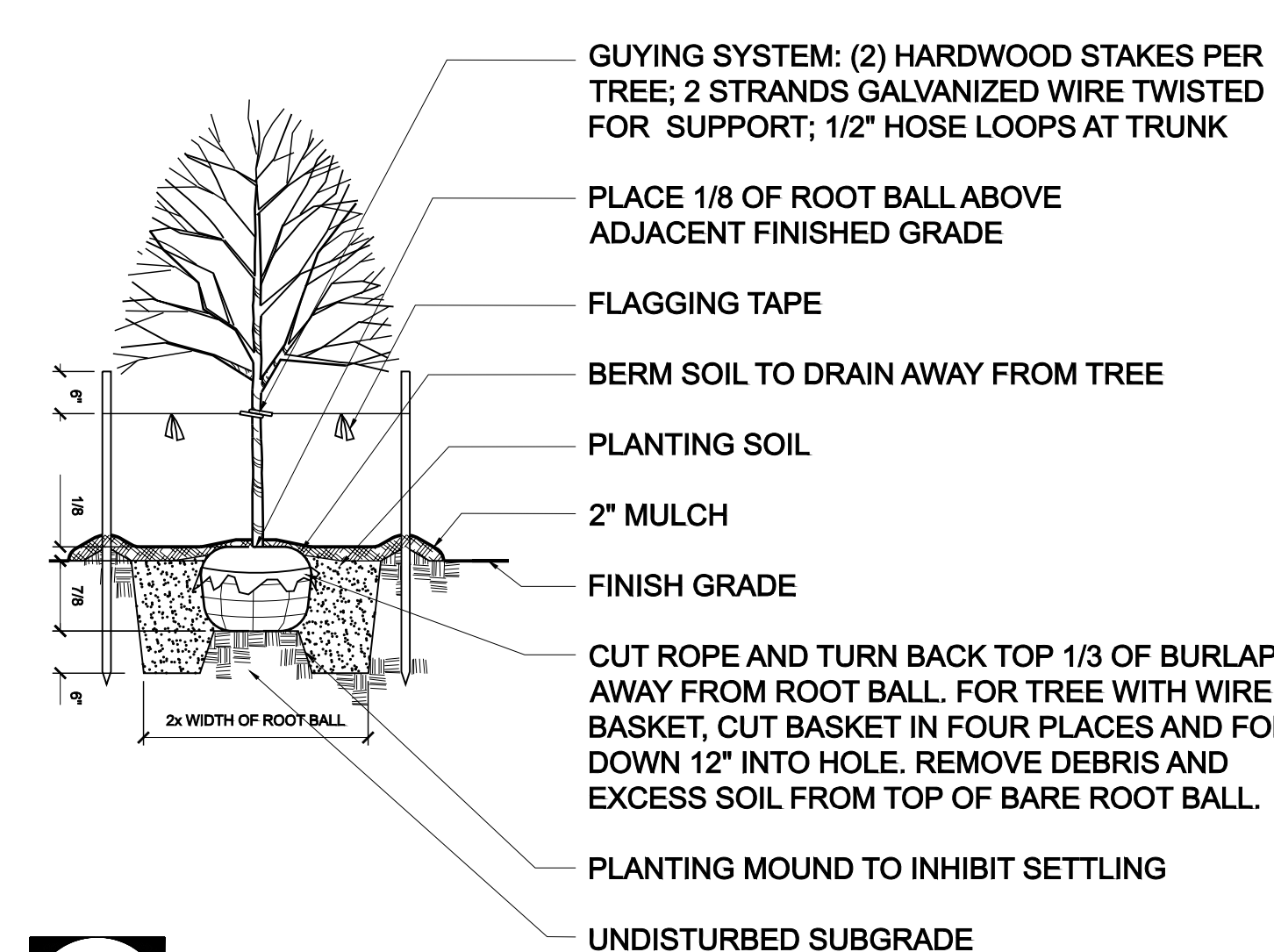
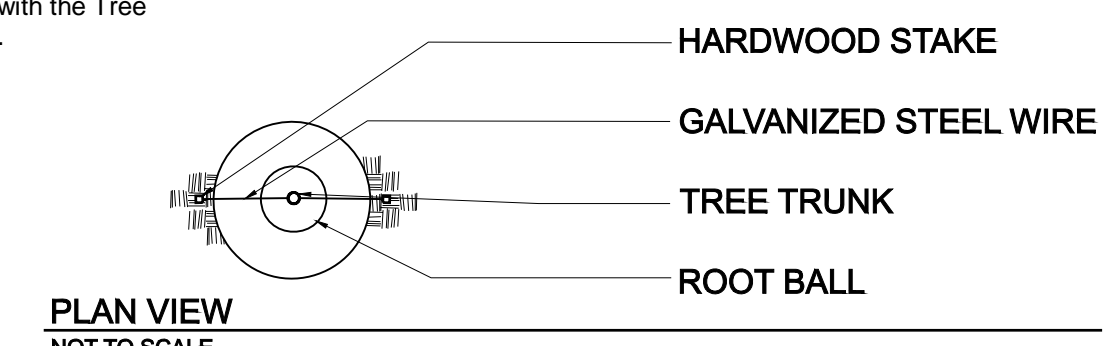

A
L-1 BGE PLANTING PLAN
1" = 40' - 0"

B
L-1 TREE PLANTING DETAIL
1/2" = 1' - 0"

ST. MARY'S PARK
BALTIMORE, MD

95% PROGRESS
NOT FOR CONSTRUCTION

BALTIMORE CITY
RECREATION AND PARKS
200 MADISON STREET
BALTIMORE MD, 21217
Phone: 410.396.7948

Sheet Title

BG&E PLANTING PLAN

Project No. _____ DGN File: _____

Scale: AS NOTED Date: 06-17-2009

Drawn by: JAG Checked by: SCS

Sheet Number

